

# Installation Manual

BMW X3 5DR  
BMW-X3-5-C



## Shades



Side Shades



Port Shades



Tailgate Shades

## Fixing Clips



CL-M02 x 8



CL-M03 x 4



CL-M01 x 2



CL-M12 x 2



CL-M14 x 1



# Installation

BMW X3 5DR  
BMW-X3-5-C

## Components Needed

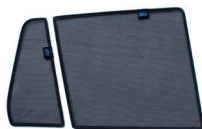

Side Shades



CL-M03 x 4



CL-M02 x 4

## Side Shade Installation

### STEP 1



### STEP 2



Window must be down and shade fitted from the outside

### STEP 3



### STEP 4



### STEP 5

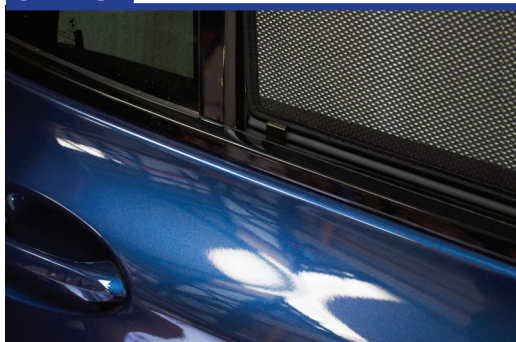

### STEP 6



# Installation

BMW X3 5DR  
BMW-X3-5-C



## Side Shade Installation

### STEP 7

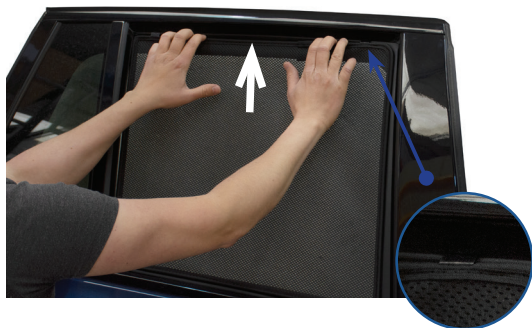

### STEP 8



### STEP 9



### STEP 10



### STEP 11



### STEP 12



**Repeat this whole process for the other side.**

# Installation

BMW X3 5DR  
BMW-X3-5-C

## Components Needed



Port Shades



CL-M02 x 4

## Port Shade Installation

### STEP 1

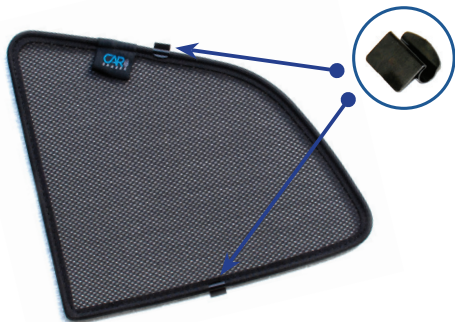

### STEP 2



### STEP 3



### STEP 4



### STEP 5



### STEP 6



Repeat this whole process for the other side.

# Installation

BMW X3 5DR  
BMW-X3-5-C

## Components Needed



Tailgate Shades



CL-M14 x 1



CL-M01 x 2



CL-M12 x 2

## Tailgate Shade Installation

### STEP 1

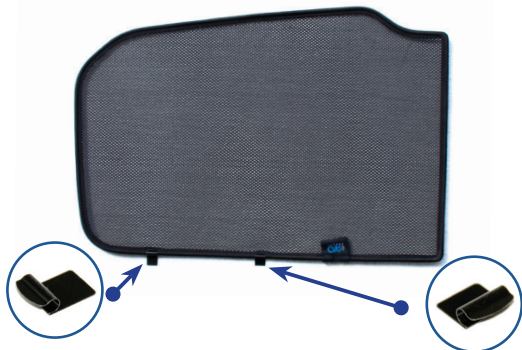

### STEP 2



### STEP 3



### STEP 4



### STEP 5

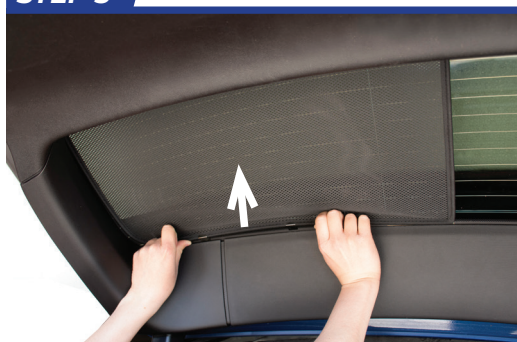

### STEP 6



# Installation

BMW X3 5DR  
BMW-X3-5-C



## Tailgate Shade Installation

### STEP 7



Repeat this whole process for the other side.

### STEP 8



### STEP 9

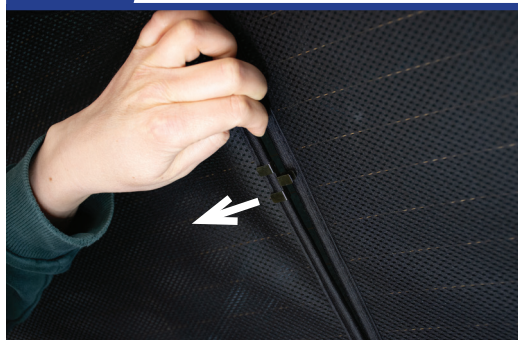

### STEP 10

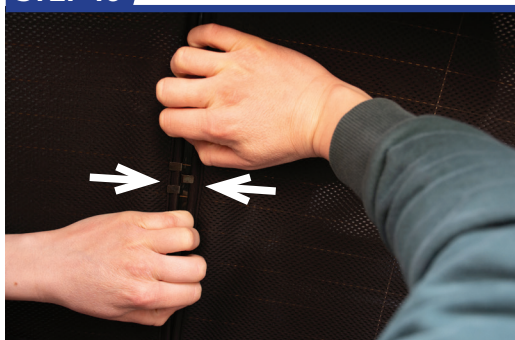

### STEP 11

