

# Installation Manual

BMW X6 5DR  
BMW-X6-5-B



## Shades

## Fixing Clips



Side Shades



Port Shades

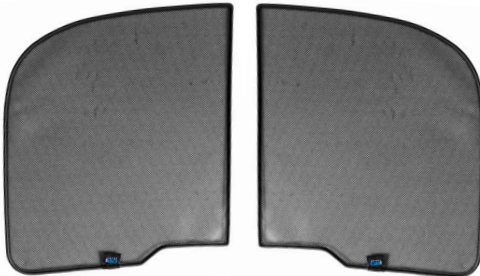

Tailgate Shades



CL-M12 x 4



CL-M02 x 8



CL-M14 x 1



CL-M03 x 4



CL-M04 x 4



# Installation

BMW X6 5DR  
BMW-X6-5-B

## Components Needed



## Side Shade Installation

### STEP 1

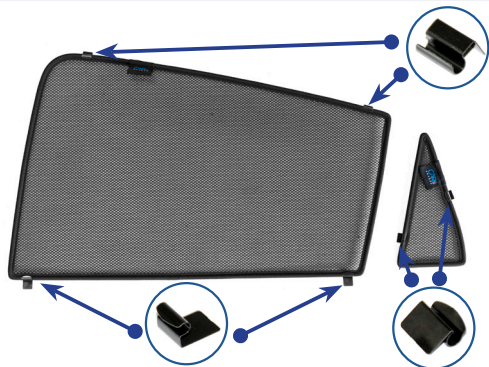

### STEP 2



### STEP 3



### STEP 4



### STEP 5



### STEP 6



# Installation

BMW X6 5DR  
BMW-X6-5-B



## Side Shade Installation

### STEP 7



### STEP 8



### STEP 9

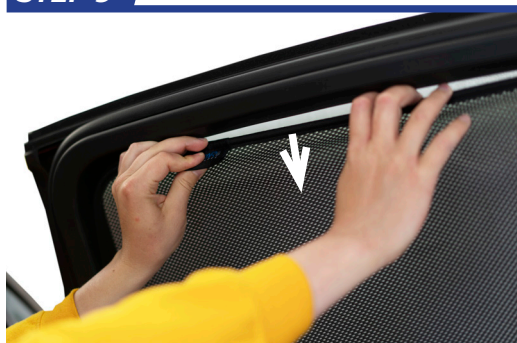

### STEP 10



### STEP 11

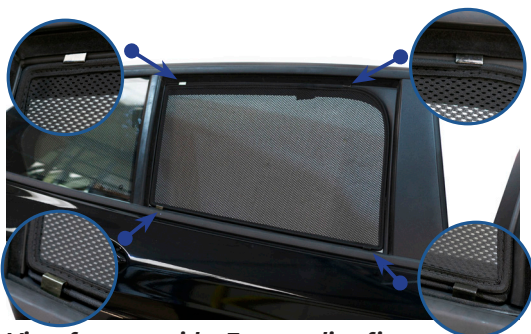

*View from outside. Ensure clips fit behind seals.*

### STEP 12



*Repeat this whole process for the other side*



# Installation

BMW X6 5DR  
BMW-X6-5-B

## Components Needed

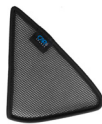

Port Shades



CL-M02 x 4

## Port Shade Installation

### STEP 1

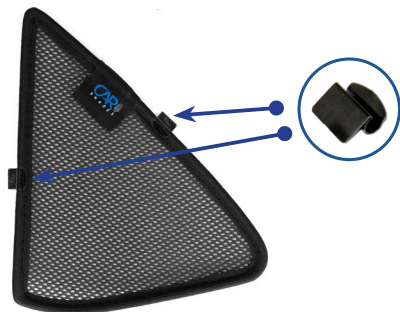

### STEP 2

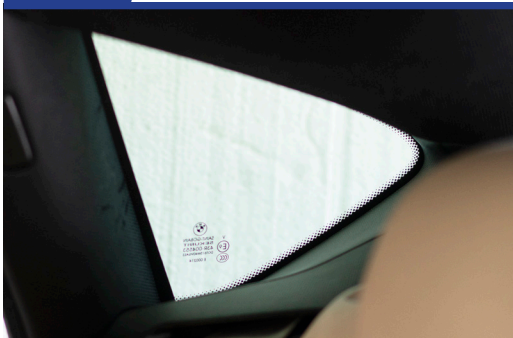

### STEP 3



### STEP 4

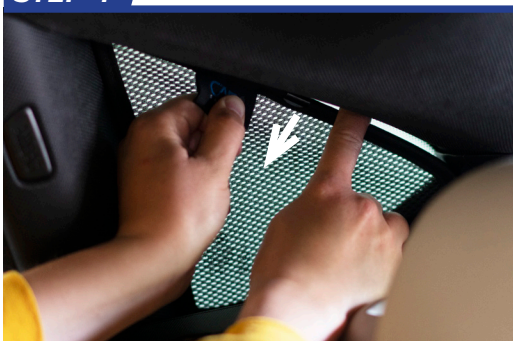

### STEP 5

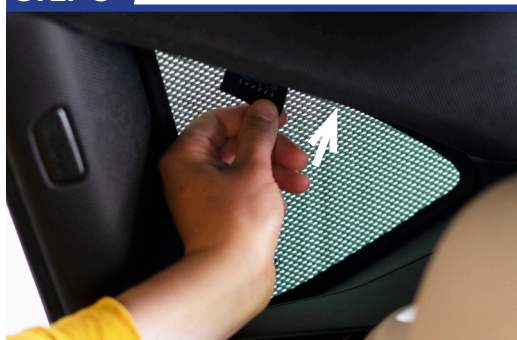

### STEP 6



Repeat this whole process for the other side.

# Installation

BMW X6 5DR  
BMW-X6-5-B

## Components Needed

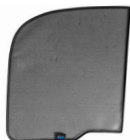

Tailgate Shades



CL-M12 x 4



CL-M14 x 1

## Tailgate Shade Installation

### STEP 1

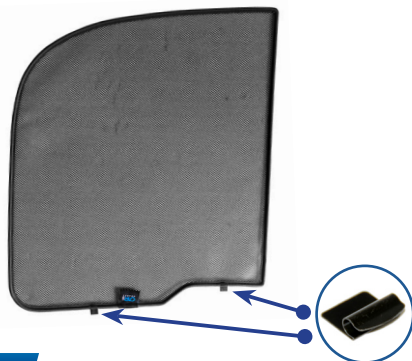

### STEP 2



### STEP 3



### STEP 4

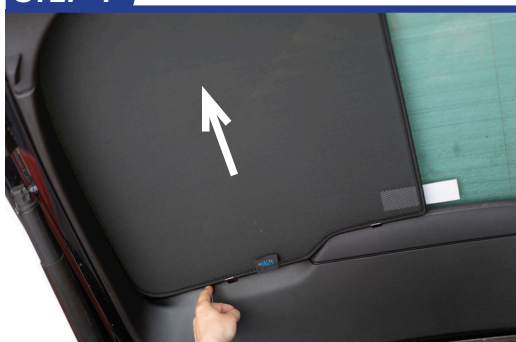

### STEP 5



### STEP 6

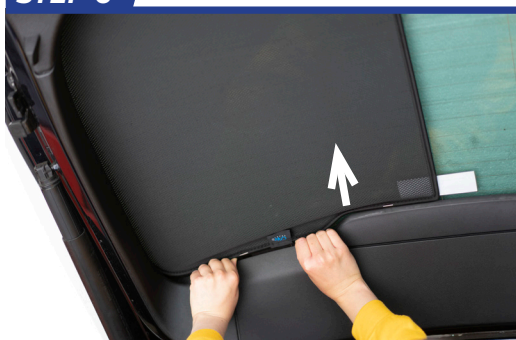



# Installation

BMW X6 5DR  
BMW-X6-5-B



## Tailgate Shade Installation

### STEP 7



### STEP 8



Repeat this whole process for the other side

### STEP 9

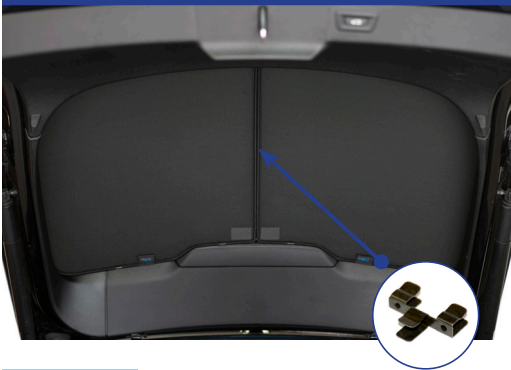

### STEP 10



### STEP 11

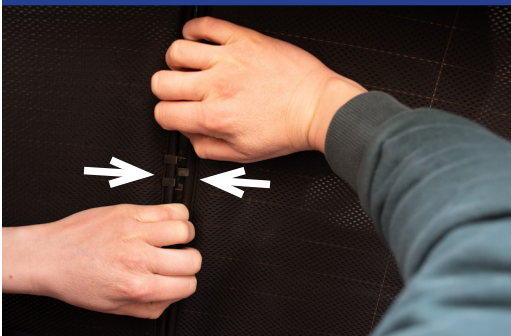

### STEP 12

