

Installation Manual

PEUGEOT 308 ESTATE
PEU-308-E-B-18



COMPONENTS INCLUDED



FIXING CLIPS



CL-M05 x 2



CL-M12 x 2



CL-T01 x 1

CAR[®]
S H A D E S

Side Shade Installation

PEUGEOT 308 ESTATE
PEU-308-E-B-18

COMPONENTS NEEDED:

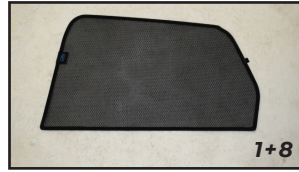

STEP #1

INSERT CLIPS INSIDE WEATHERSTRIP



STEP #2

POSITION THE SIDE SHADE

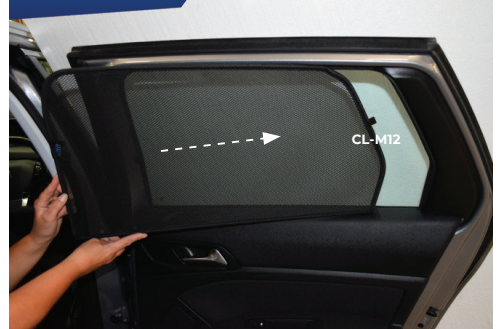

STEP #3

ATTACH SIDE SHADE BEHIND CLIPS



STEP #4

ENSURE SECURELY FITTED IN PLACE

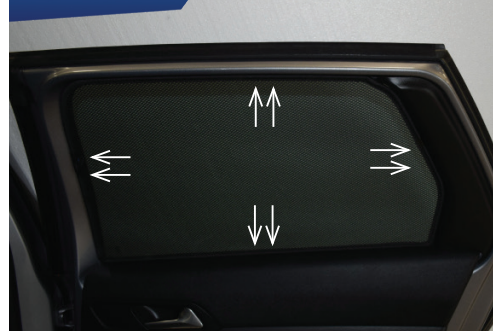

CAR
SHADES